

ROMA X

INSTALLATION MANUAL - KD60



SUPER EASY INSTALL



HOSPITALITY DIVISION
eurotech
LUXURY SHOWER DOORS



inside door left



inside door right

HARDWARE PRE-CUT TO FIT 57" TO 59" WIDE OPENINGS

Tools Required

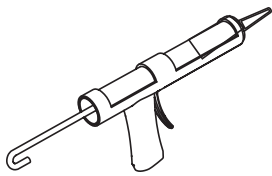

Silicone

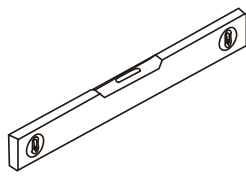

Level

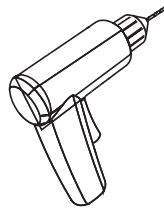

Drill

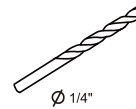

Masonry Bit

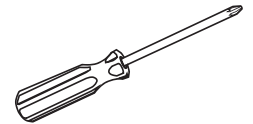

Screwdriver
(Phillips)

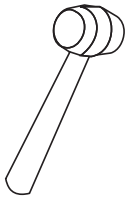

Mallet



Pencil

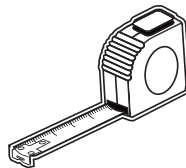

Tape Measurer

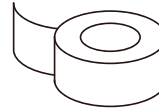

Painters
Tape

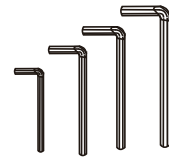

Allen Wrenches
(included)



This product is heavy and may require two people to install.



Congratulations on your purchase of your Eurotech Shower door, making your shower dreams come to life.

◆ Assembly Drawing

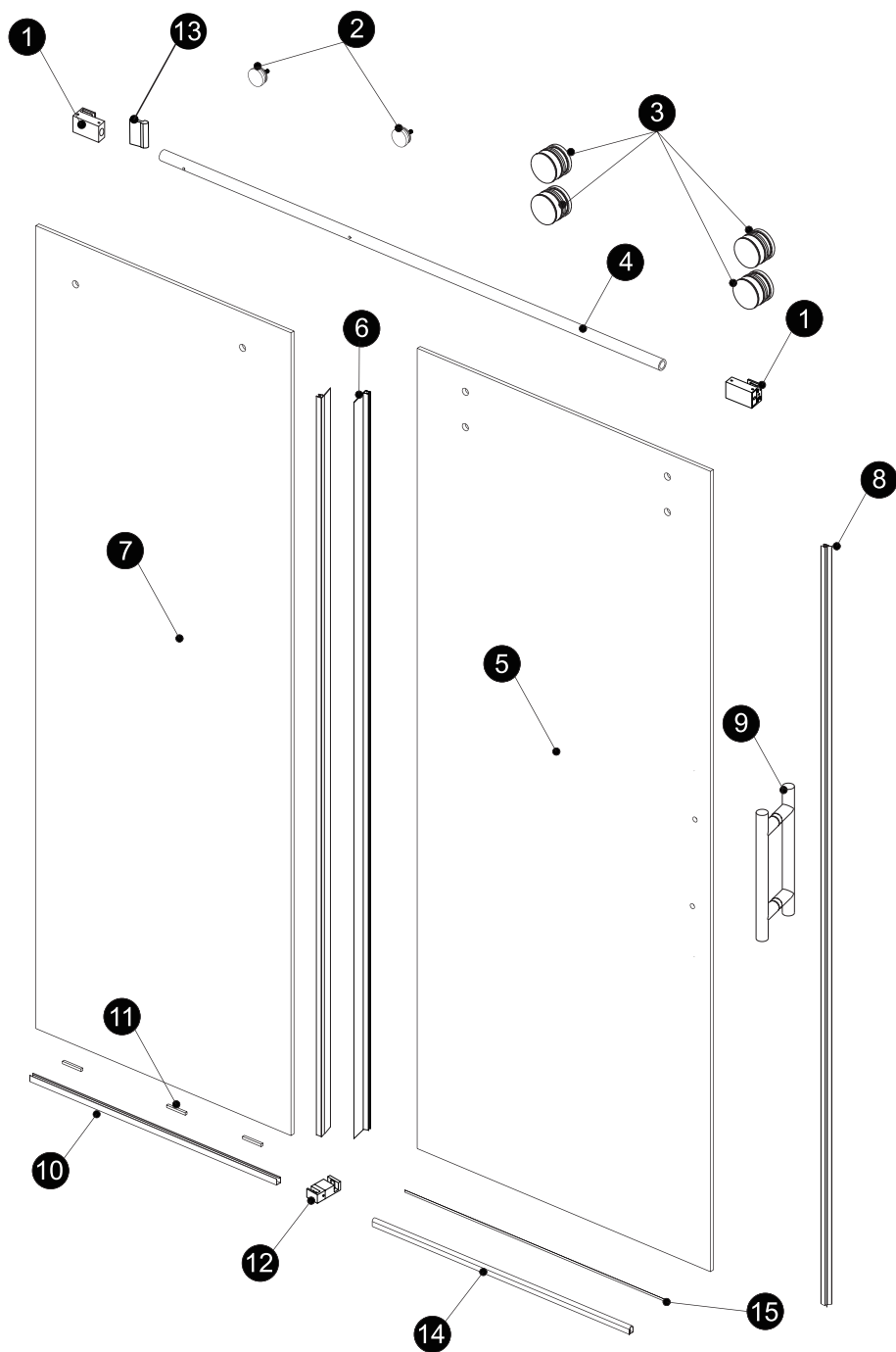

PACKING LIST

PART #	DESCRIPTION	Q'TY	PART #	DESCRIPTION	Q'TY
1	Wall Bracket	2pcs	9	Handle	1pc
2	Fixed Panel Holders	2pcs	10	Aluminium Bottom U Channel	1pc
3	Roller	4pcs	11	1/4" Cushions	3pcs
4	Track	1pc	12	Bottom Guide	1pc
5	Door Panel	1pc	13	Safety Bumper	1pc
6	F Seal	2pcs	14	Aluminium Water Guard	1pc
7	Fixed Panel	1pc	15	L Seal	1pc
8	V Seal	1pc			



inside door left



inside door right

Bar Installation: Mount wall bracket on high side of curb first. Level bar to mark opposite wall for second wall bracket.

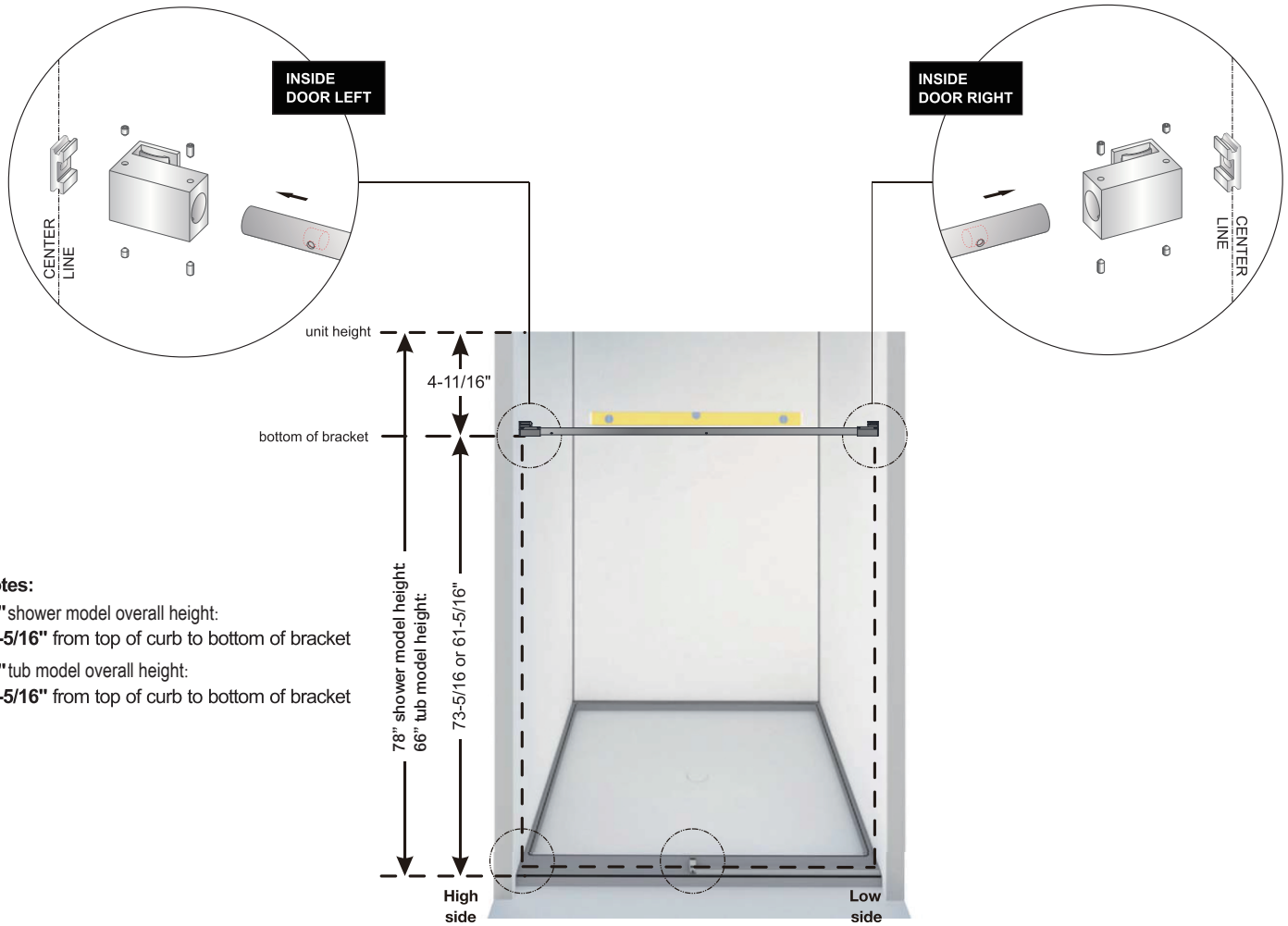

Notes:

78" shower model overall height:
73-5/16" from top of curb to bottom of bracket
66" tub model overall height:
61-5/16" from top of curb to bottom of bracket

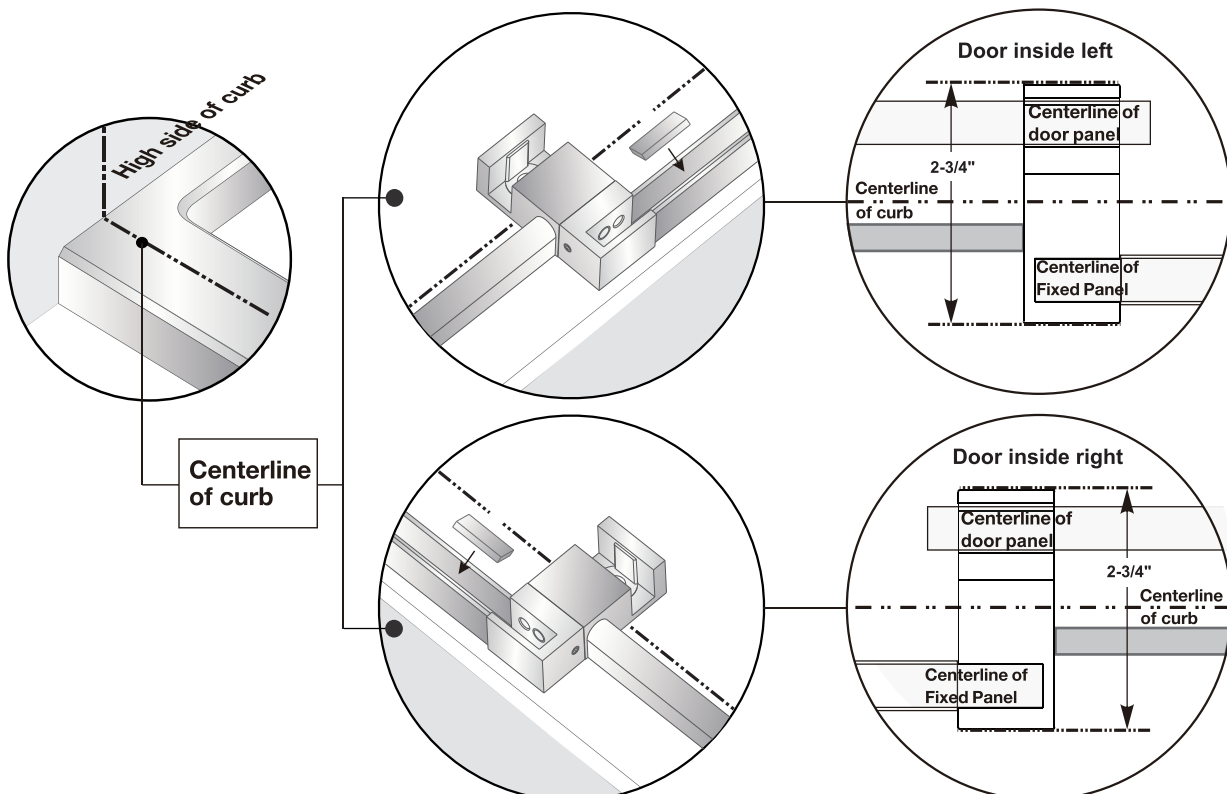

Aluminum Channel Cut Formula: overall fixed panel width minus 1-1/16"

Inside door left

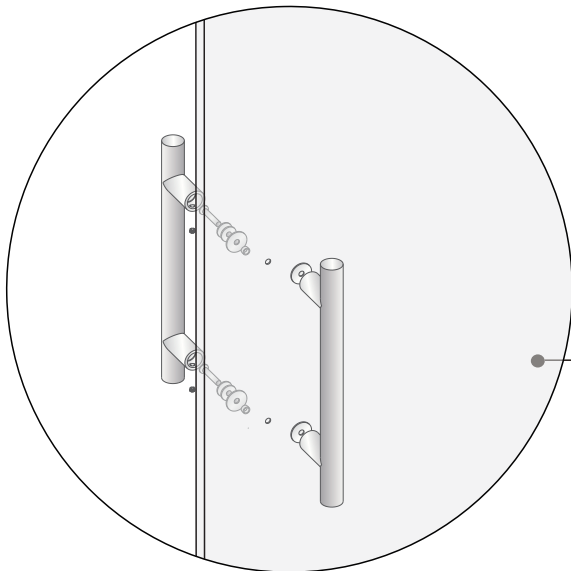
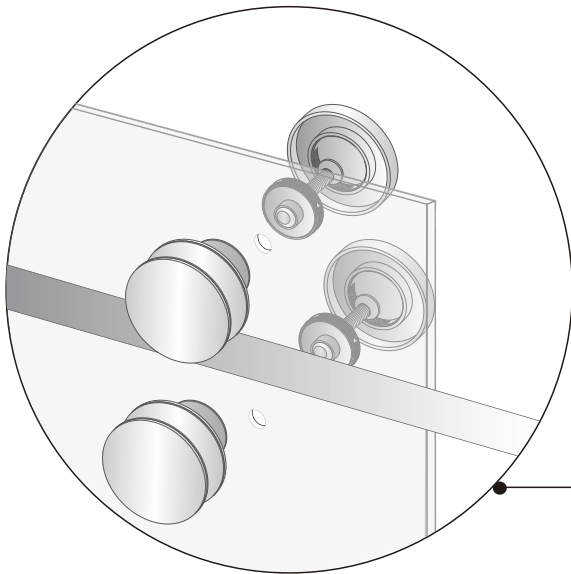
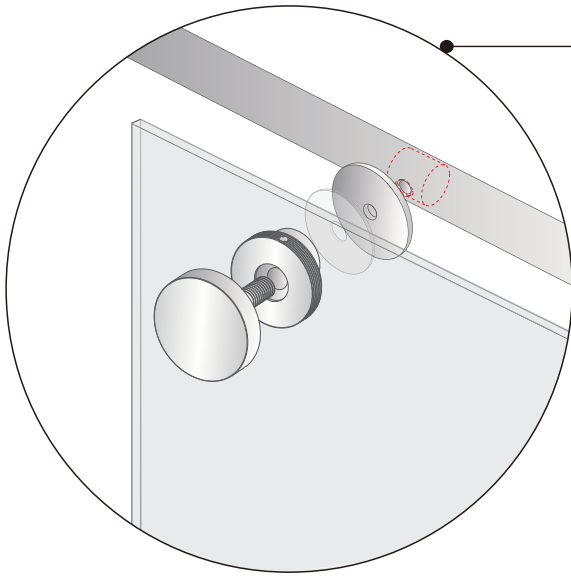

Inside door right

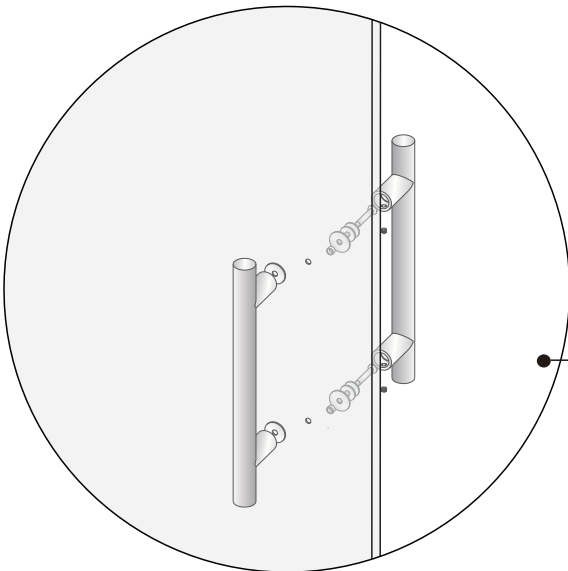
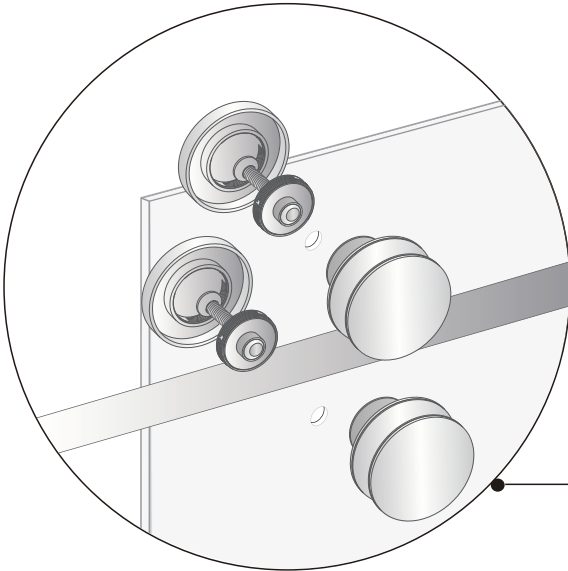
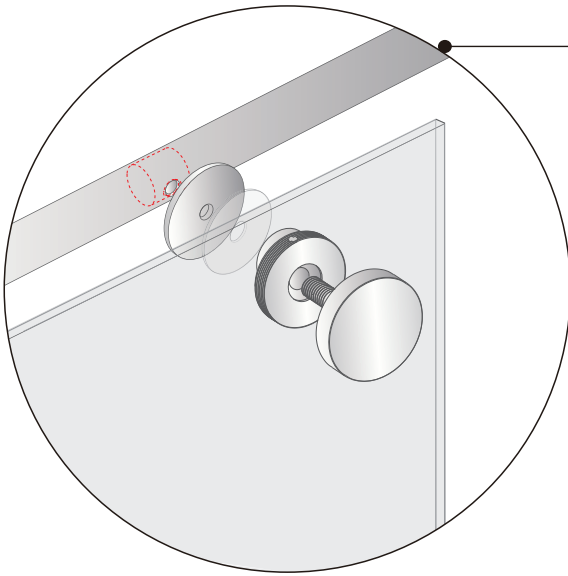

Aligning doors to wall via adjusting rollers

Loosen main allen screw and turn metal bushing left or right to raise or lower door.
Tighten main allen screw.

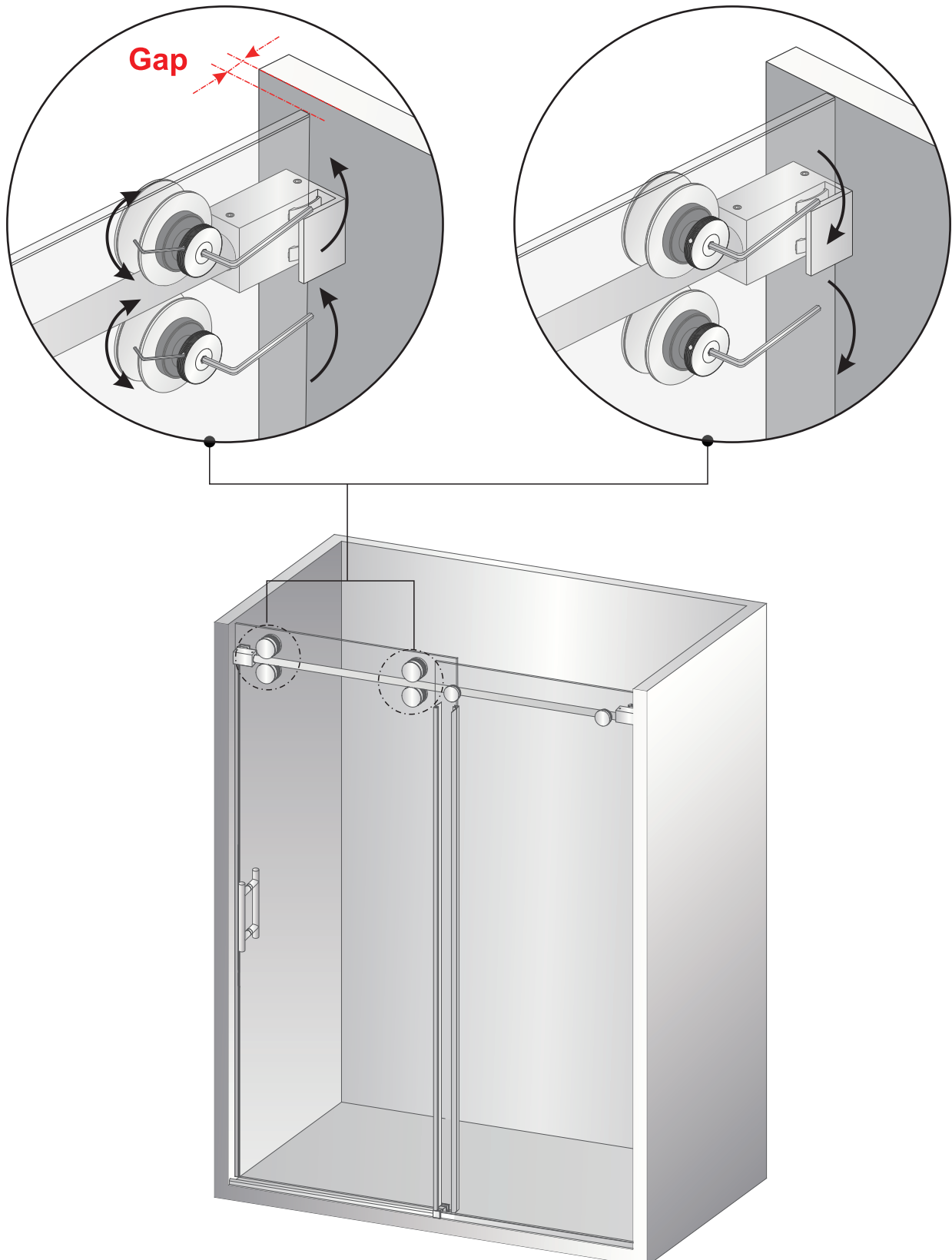

For outside door left insert safety bumpers into wall brackets as shown

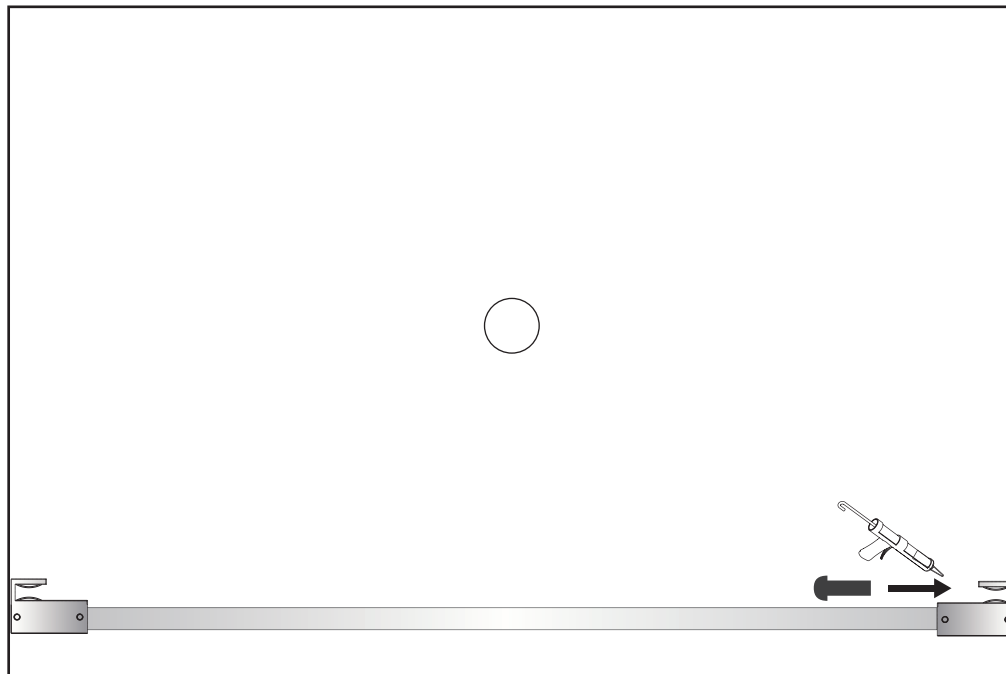

For outside door right insert safety bumpers into wall brackets as shown

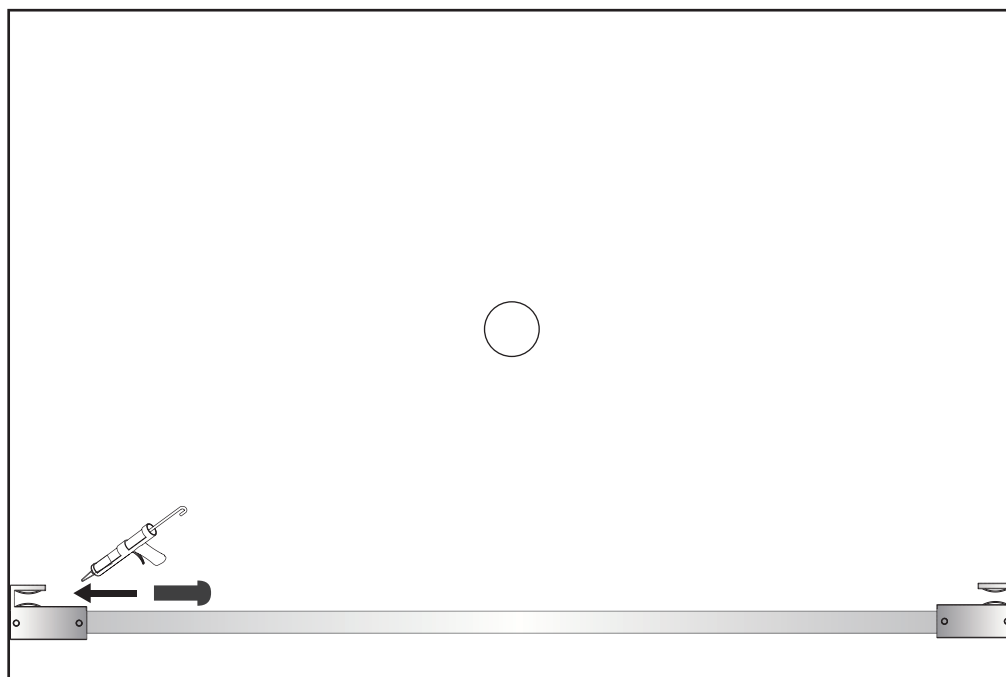

DO NOT OPERATE DOORS WITHOUT SAFETY BUMPERS AND SEALS PROPERLY INSTALLED

◆ Seal Page

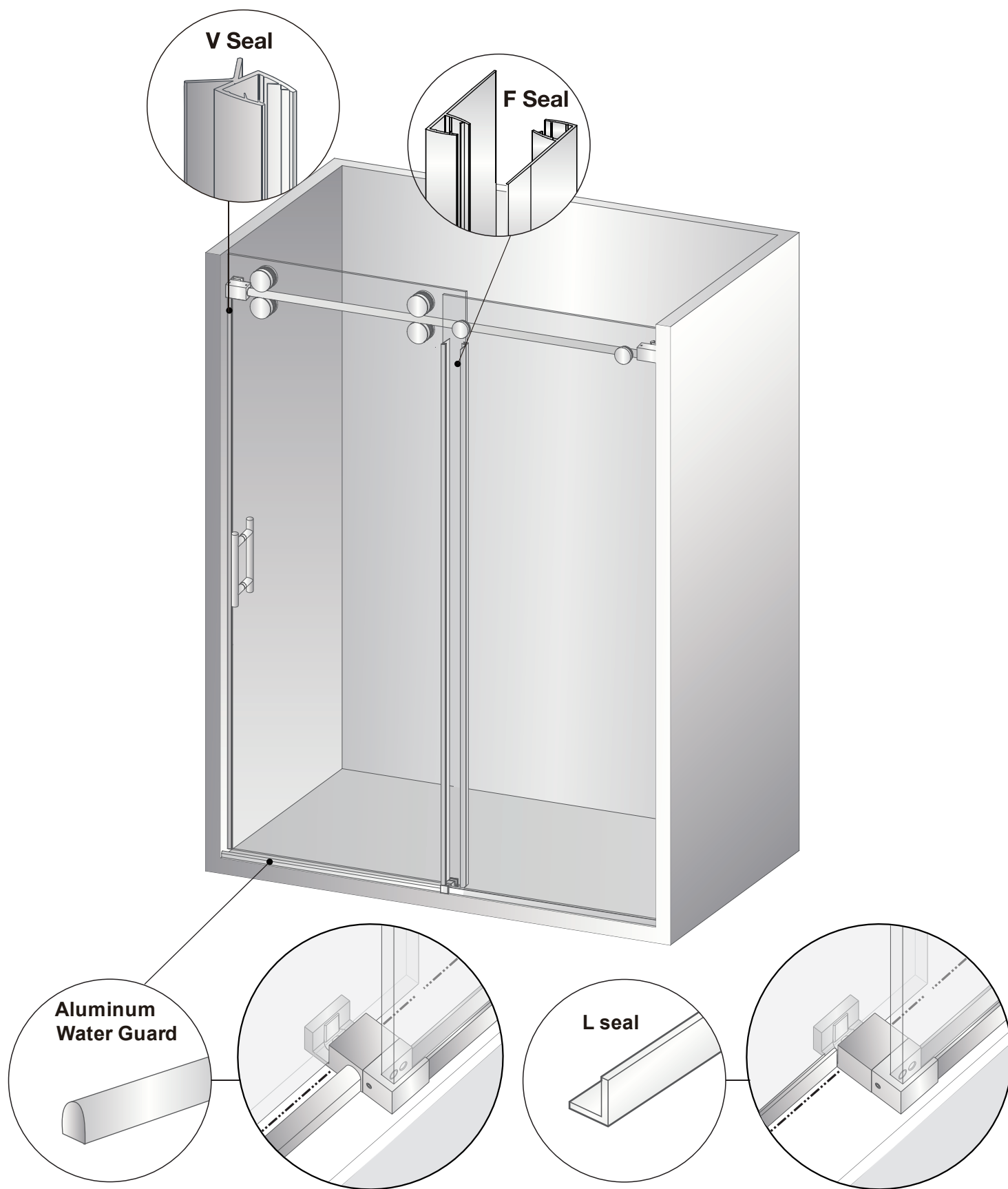

Preferred method: aluminum water guard
Cut to fit between wall and guide

Optional method: polycarbonate L-seal
Cut to fit between wall and guide

DO NOT OPERATE DOORS WITHOUT SAFETY BUMPERS AND SEALS PROPERLY INSTALLED